

Gas ball valves with swivel nut

Art. 7018 – 7553 - 7200

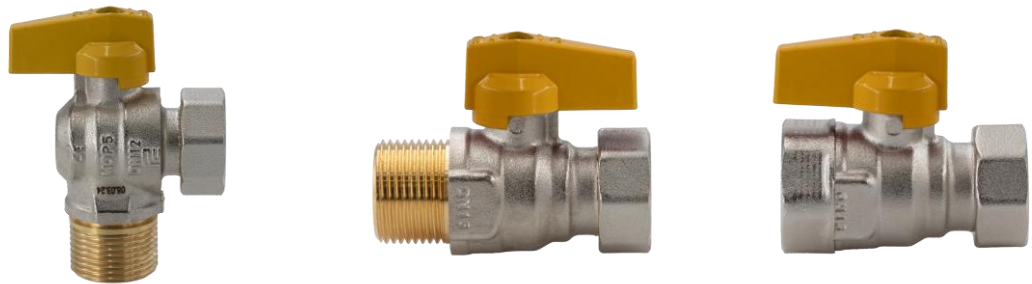

100% MADE IN ITALY 

Function Pintossi + C gas ball valves with swivel nut are the perfect solution for boiler gas inlets installation, gas meters connections and in general for gas systems.
The compact specific design of the valves makes them suitable to be installed even in reduced spaces.
The **monoblock body** has been designed in order to have the lowest number of sealings, making them very strong and reliable even on high pressure systems and worst conditions.
Certified EN 331:1998 + A1:2010 in compliance with Regulation (EU) No. 305/2011 of the European Parliament and of the Council of 9 March 2011.
Nickel plated.

Product range	Art.7018	1/2" x 1/2"	FF Straight ball valve with swivel nut nickel plated
		3/4" x 3/4"	FF Straight ball valve with swivel nut nickel plated
		1" x 1"	FF Straight ball valve with swivel nut nickel plated
	Art.7553	1/2" x 1/2"	MF Straight ball valve with swivel nut nickel plated
		3/4" x 3/4"	MF Straight ball valve with swivel nut nickel plated
		1" x 1"	MF Straight ball valve with swivel nut yellow
	Art.7200	1/2" x 1/2"	MF Angle ball valve with swivel nut nickel plated
		3/4" x 3/4"	MF Angle ball valve with swivel nut nickel plated
		1" x 1"	MF Angle ball valve with swivel nut yellow

Technical specifications	Fuel gas:	Town gas (I family), Natural gas (II family), LPG gas (III family) according to European Norm EN 437
	Min. working temp.:	-20°C
	Max. working temp.:	60°C
	Max. working pressure:	MOP5

Materials

Body:	Brass CW617N
Ball:	Brass CW617N chromed plated
Nut:	Brass CW614N
Stem:	Brass CW614N
Seat:	PTFE
Gaskets:	NBR
Handle:	Aluminum

Dimensions

ART. 7018

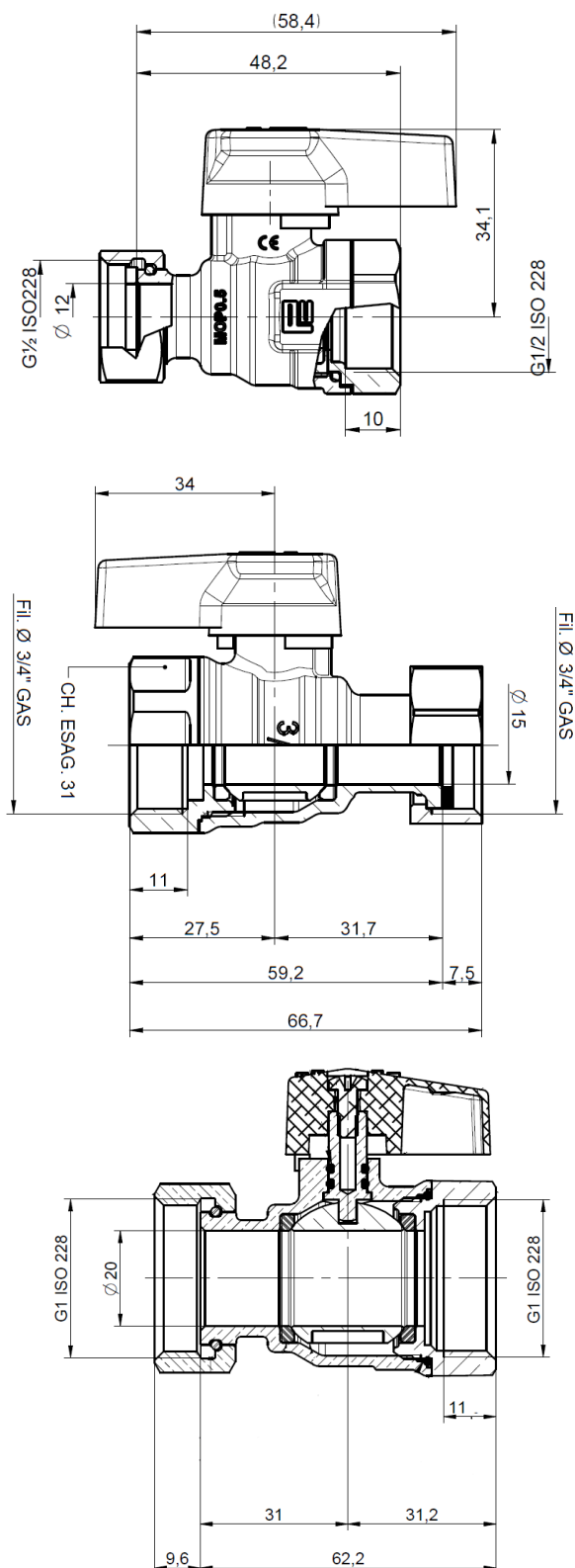

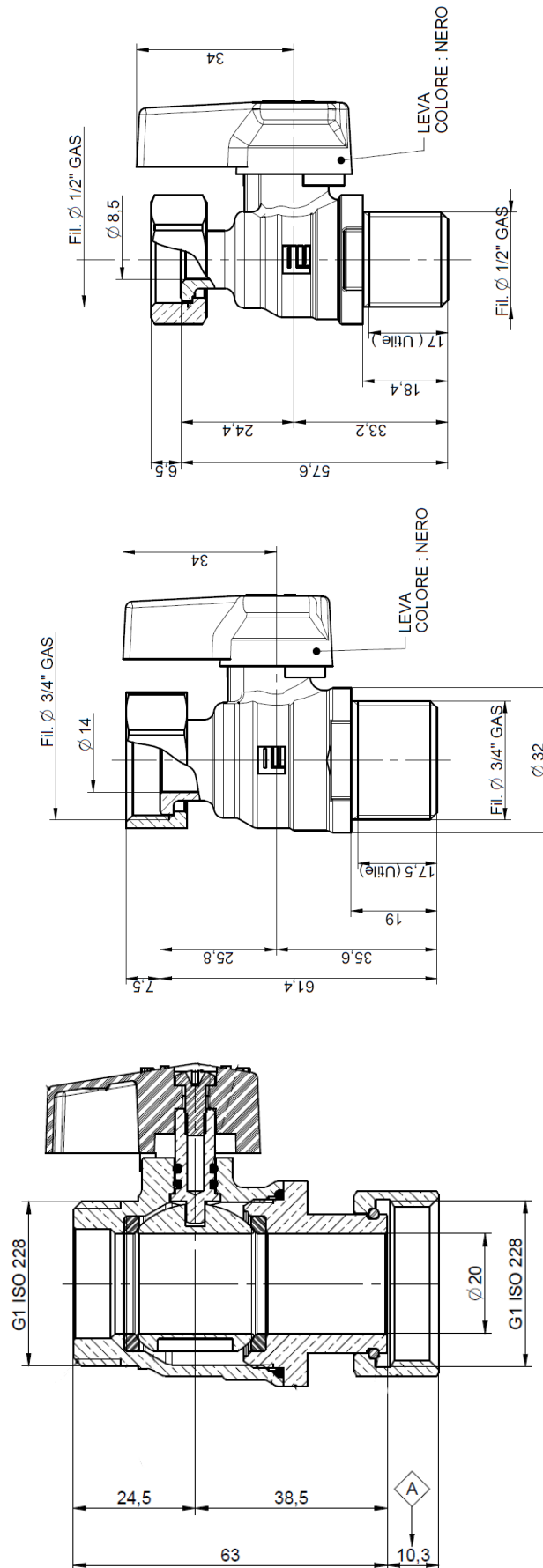

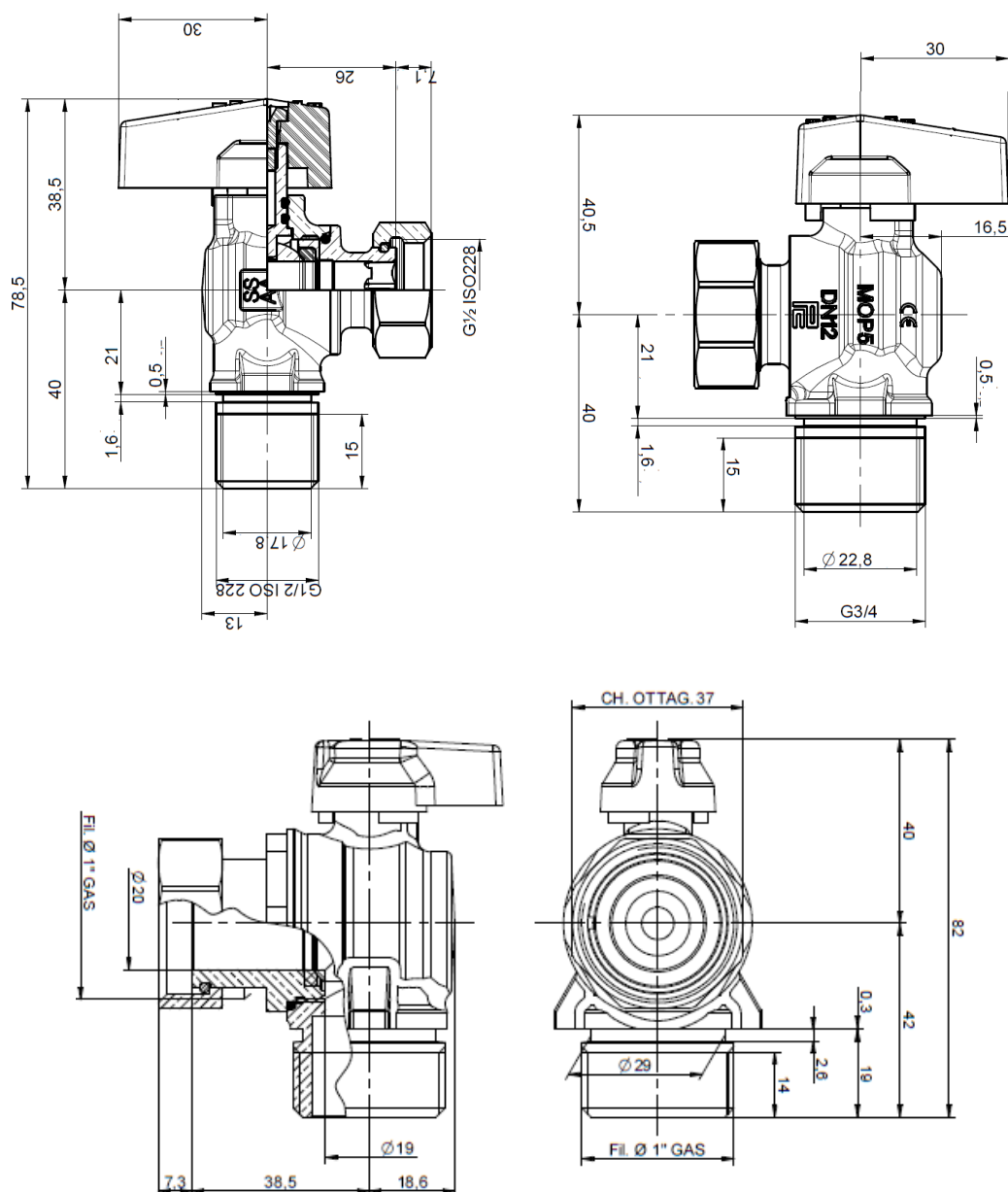

Monoblock body

Ball valves with swivel nut series 7200-7018-7553 are built using a **single piece body**, avoiding in this way to have multiple components connections in the most stressed part during installation and handling. This particular geometry allows to avoid possible leakages, granting a correct functioning even with **very high pressures**.

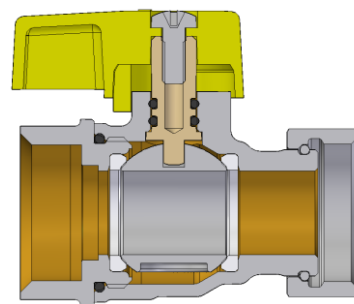

Installation

The valve must be installed in the part of the connection with the swivel nut using an appropriate gasket with a thickness of at least 2mm and must be attached to the liner in a such way that it cannot be accidentally detached.